

Initial SuperFlow Wi-Fi Setup

1. What is SuperFlow and what will it do now?

SuperFlow is a smart device that is installed on the motorcycle and works from the first moment, even without needing to configure it or connect it with the mobile phone.

When it is switched on for the first time:

- SuperFlow automatically enters a standard operating mode with a medium fuel enrichment level.
- This mode is designed to ensure the bike functions correctly and safely from the start.
- In other words, you can use the bike without any further adjustments.

Connecting to SuperFlow or configuring it is not mandatory for it to work.

However, configuration is recommended because it allows:

- Adjusting SuperFlow operation to your riding style.
- Customizing parameters such as enrichment level.
- Viewing real-time information and data.
- Taking full advantage of advanced system features.

This manual explains how to connect to SuperFlow and configure it easily so each user can adapt it to their preferences, even though the system already works correctly from the beginning.

No application installation is required.

Everything is done from the mobile web browser (Chrome, Safari, etc.).

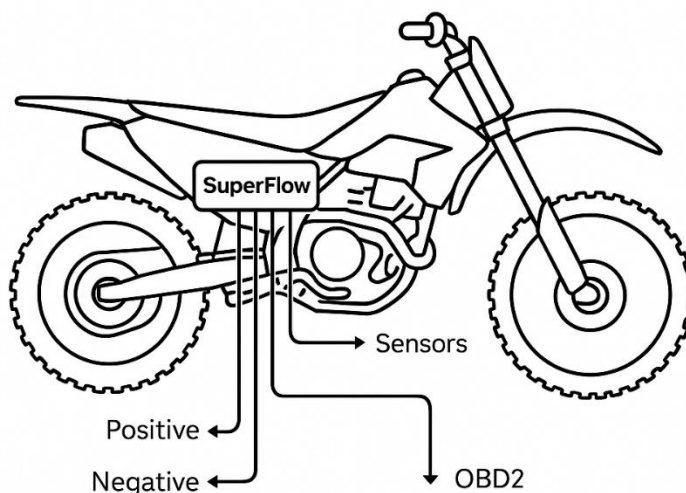

2. What is a hotspot

A hotspot, also called a “Wi-Fi zone” or “Internet sharing”, is a mobile phone function that:

- Creates its own Wi-Fi network
- Works like a router
- Allows other devices to connect
- Shares the phone Internet connection

In this process:

- The mobile phone acts as a router
- SuperFlow connects to the mobile phone
- You access SuperFlow through this network

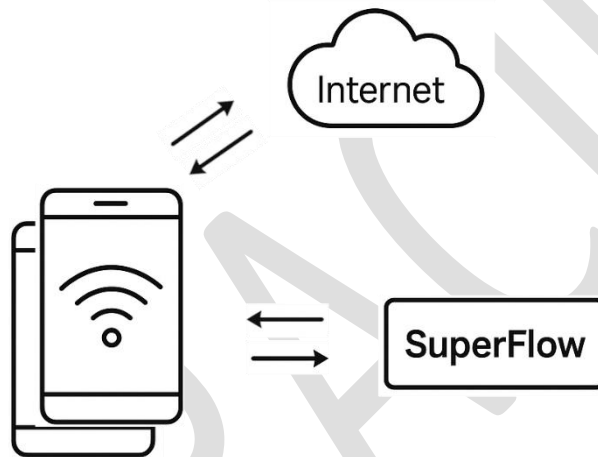

3. Turning on SuperFlow for the first time

1. Install SuperFlow on the motorcycle
2. Turn on the motorcycle or power the SuperFlow
3. Wait approximately 30 seconds

SuperFlow automatically creates its own Wi-Fi network for initial configuration.

4. Connecting to SuperFlow for the first time

1. Take your mobile phone
2. Go to Settings → Wi-Fi
3. Look for a network called:

SuperFlow-XXXX

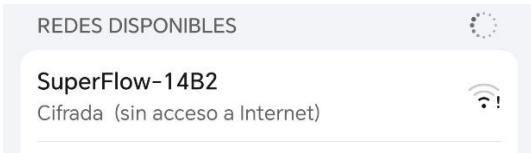

4. Tap on that network
5. Enter the password supplied with the SuperFlow device

5. Opening the SuperFlow page

1. With the phone connected to SuperFlow-XXXX
2. Open the browser (Chrome or Safari)
3. Enter the following address exactly:

http://192.168.4.1

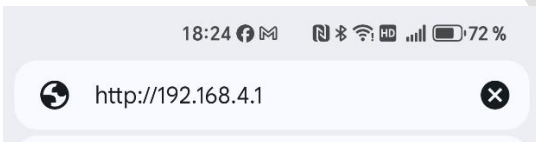

4. Press Enter

The SuperFlow main page will open.



6. Choosing the usage mode

After reaching the initial screen, the phone is connected to the SuperFlow network. Therefore, the phone and SuperFlow do not have Internet access. You can continue configuring SuperFlow this way, but you will not receive notifications or external communication.

The recommended method is to turn the phone into a Wi-Fi hotspot so SuperFlow connects to it. This way, both the phone and SuperFlow will have Internet access.

Recommended: Use SuperFlow with Internet

- Phone creates a hotspot
- SuperFlow connects to the hotspot
- Internet access and real-time data

7. Activating hotspot on the mobile phone

Android:

1. Settings
2. Wi-Fi hotspot / Internet sharing
3. Enable portable Wi-Fi hotspot



Settings → Hotspot



Notifications panel

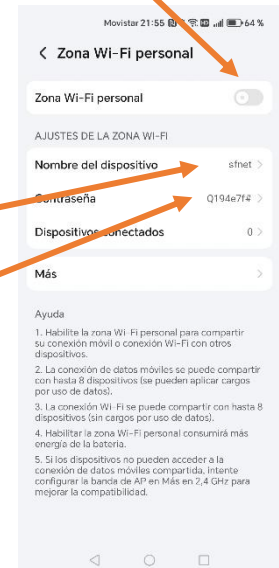

1. Set device name
2. Set password
3. Enable portable Wi-Fi

iPhone:

1. Settings
2. Personal Hotspot
3. Enable “Allow Others to Join”

Note:

- Hotspot name
- Hotspot password

8. Entering hotspot data into SuperFlow

Navigate to the Wi-Fi Configuration screen:

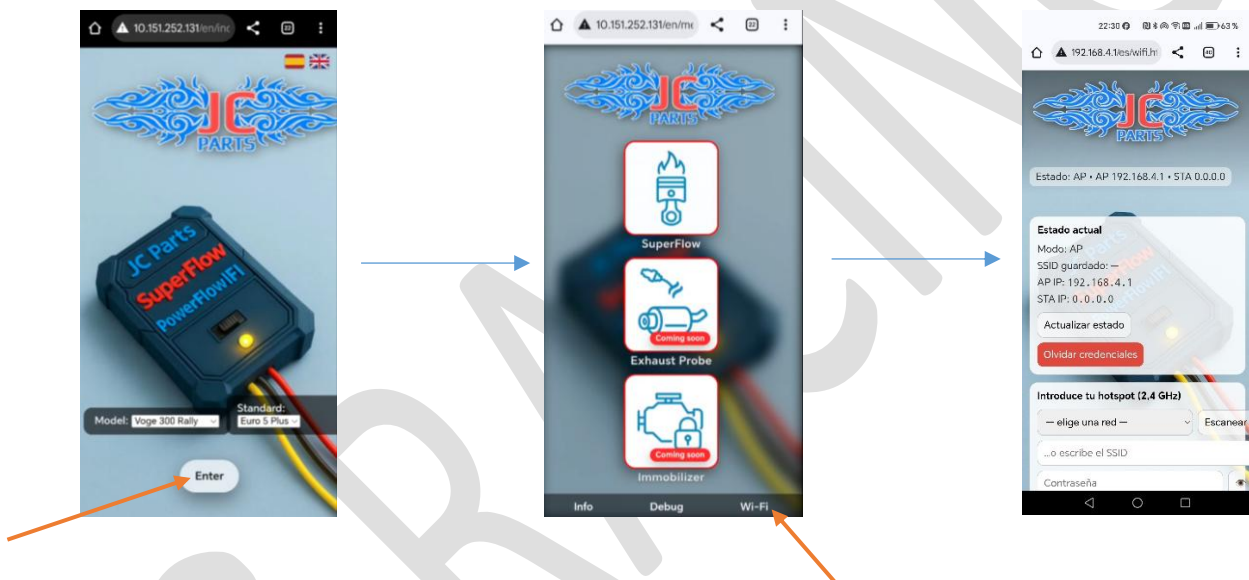

On the Wi-Fi configuration page:

1. Enter the exact hotspot name
2. Enter the password
3. Press “Save and connect”



9. Successful connection and SuperFlow address

When the connection is successful, the screen shows:

- The text: Connected!
- A SuperFlow address, for example: <http://10.83.254.70>

10. Opening SuperFlow from the hotspot network

1. Press “Open now”
2. The browser reloads
3. You are now connected to SuperFlow through the hotspot

The SuperFlow-XXXX network may disappear. This is normal.

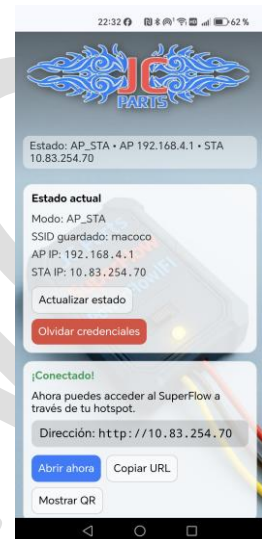

11. Saving access for daily use

Android (Chrome):

1. Menu (three dots)
2. “Add to home screen”



Tap on the three dots



Add to home screen

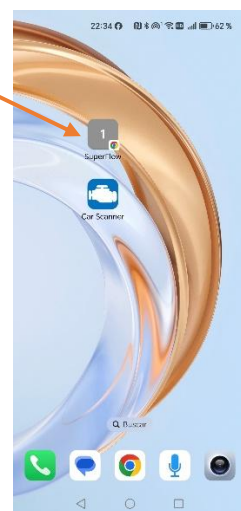

SuperFlow home screen icon

iPhone (Safari):

1. Share button
2. "Add to home screen"

12. Normal usage from now on

Whenever you use the motorcycle and want to configure SuperFlow or view live information:

1. Turn on the motorcycle
2. Activate the mobile hotspot
3. Tap the SuperFlow icon
4. Use the system normally

SuperFlow works autonomously and does not require mobile connection to operate, only to change enrichment settings.

13. What happens if the SuperFlow address changes

Your Wi-Fi hotspot may occasionally change the IP address assigned to connected devices. As a result, even with everything correctly configured, you may sometimes be unable to reconnect to SuperFlow.

If the saved access does not work:

1. Go back to your Wi-Fi hotspot settings
2. Tap on "Connected devices"
3. You will see the new address of your SuperFlow
4. Write down the new address
5. Open the SuperFlow shortcut from the home screen
6. Replace the old address with the new one you wrote down

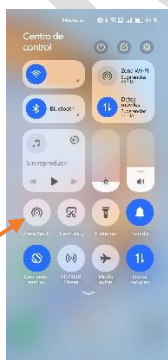

Vaya a Zona Wifi

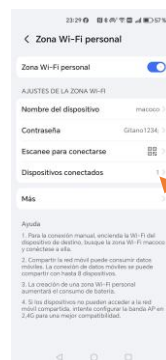

Connected devices



New direction

14. Quick summary

1. Connect to SuperFlow-XXXX
2. Open 192.168.4.1
3. Activate hotspot
4. Enter name and password
5. Tap “Open now”
6. Save access

